



Fitting Instructions

TOWBAR FT58R
for FIAT PUNTO
2000-

MATERIALS

A	1	Cross Bar
D	1	Left Hand Sidearm
E	1	Right Hand Sidearm
F	2	Captive M8 Nut Strap
F1	4	M12 x 35 x 1.75mm Bolts, 2 Nuts, Lock Washers and 2 Flat Washers (30mm O.D)
G	2	M10 x 30 x 1.5mm Bolts, Nuts, Lock Washers and 4 off Flat Washers (30mm O.D.)
H	2	M8 x 40 x 1.25mm Bolts, Nuts, Lock Washers and Flat Washers (30mm O.D.)
SP	2	Safety Chain Plates
J	2	M12 x 80 x 1.75 Bolts and Nyloc Nuts
R	1	Removable Towball Unit
TB	1	Towball Bag
W	1	Weather Cap

FITTING

1. Lower exhaust rear silencer and remove hanger and heat shield. Undo lower bumper fixings (4 off). Remove plastic plugs from holes in chassis at (H). Remove the left hand centre bumper tag as shown below.
2. Insert Cross Bar (A) into bumper and loosely attach using Bolts (G) with flat washers.
3. Measure 35mm forward of forwardmost fixing (H) and drill a hole of sufficient size to allow Captive Nut Strap (F) to be inserted. Position (F) over existing holes in chassis and loosely secure to Sidearms (D & E). **Note:** original exhaust hanger and heat shield are also attached to (H) on the left hand side.
4. Loosely attach Crossbar (A) to rearmost hole in Sidearms (D & E) using Bolts (F1).
5. Attach Removable Towball (R) to Mainframe (A) with Safety Chain Plates (SP) using Bolts (J).
6. Using Crossbar (A) as a guide drill (12.5) holes for forward Bolts (F1) and secure assembly to vehicle using Bolts (F1) with Flat Washers fitted inside vertical pressing.
7. Finally tighten all bolts and replace bumper fixings and exhaust rubber.

Please refer to vehicle specification for trailer weight and nose load limits, which **must be observed**.

Recommended torque settings: M8-27Nm (20 lbs/ft), M10-58Nm (43 lbs/ft), M12-102Nm (76 lbs/ft), M16-252Nm (172 lbs/ft)

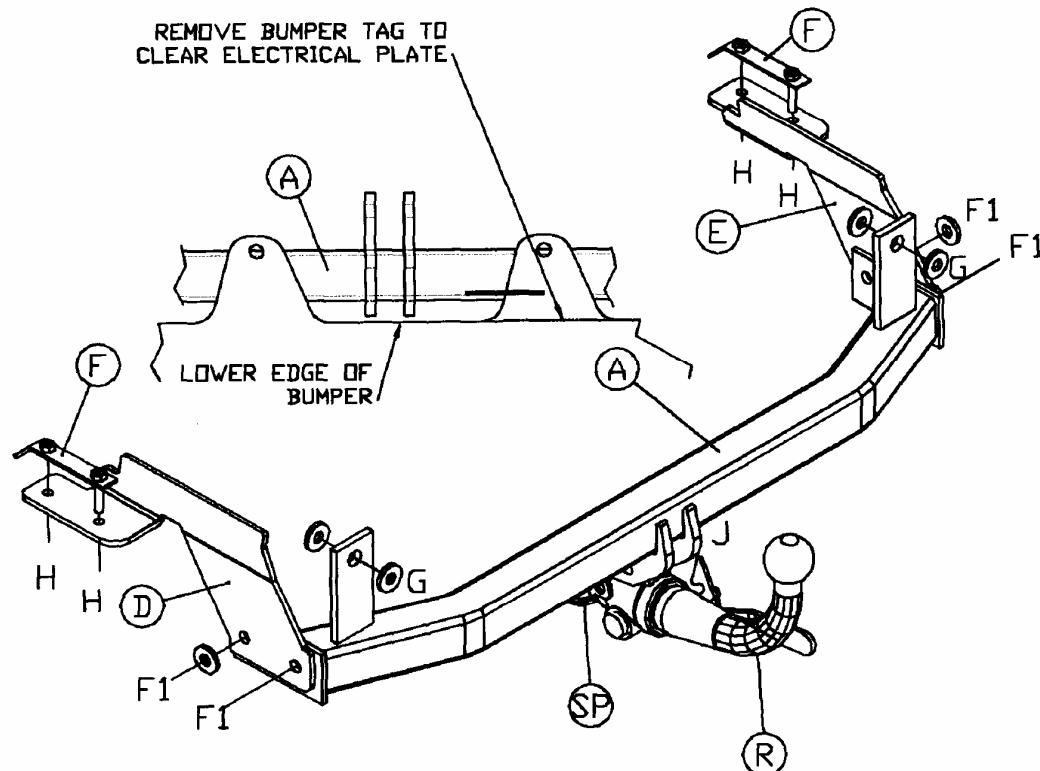



Additional Information

TOWBAR FT58
For FIAT PUNTO
2000-

Safety Recall Campaign 4616: Fiat Punto – FT58

A bulletin (Safety Recall Campaign 4616) has been issued by Fiat concerning towbars fitted to Fiat Punto cars and vans in the following chassis range:-

Cars: 00432470 onwards
04430261 onwards
05156720 onwards
02362963 onwards

Vans: 00436447 onwards

As a result of a change implemented at production, frequent, heavy and extended towing could possibly result in damage occurring adjacent to the towbar mounting point. As of which it is may be necessary for additional strengthening plates to be added to prevent damage to the towbar mountings and rear panel.

Where the towbar is a new fitting, Fiat will **not** supply the plates. Witter Towbars have therefore introduced a supplementary kit FT58-S, which is compatible with FT58 bar.

If you have recently ordered or need to fit an FT58 bar, please contact our sales department on 01244 284500 or your local stockist to obtain a FT58-S reinforcement kit.