



Fitting Instructions

TOWBAR CL114BU
For Mitsubishi Outlander 2012
and 2015 including the PHEV
Use 3003 series necks

MATERIALS

A	1	Cross Bar
C	1	Left Hand Sidearm
D	1	Right Hand Sidearm
E	4	M12 x 1.75 x 110mm Bolt, Nyloc Nut and washers (25mm O.D)
F	4	M12 x 1.75 x 40mm Bolt and Flange Nuts
G	6	M8 x 1.25 x 35mm Bolt (grade 10.9) and washers (20mm O.D)
H	4	M8 x 1.25 x 35mm Bolt (grade 10.9), Nuts and 8 washers (20mm O.D)
J	2	M12 x 1.75 x 25mm Bolt and Flange Nuts
Y	1	Spare wheel cage bracket
Y1	1	M8 x 20 x 1.25 Bolt and Nyloc Nut
ZQ	1	Neck series 3003 supplied separately
EP	1	Supplied with detachable

FITTING

1. Remove bumper.
2. Remove bolts securing bumper beam to support arms, remove support arms (not to be refitted). Fit (a few turns) Bolts (G) with washers to innermost rear panel fixings (2). (Sidearms (C) and (D) have an open slot, which will be slid under later).
3. Lower spare wheel and remove the bolts securing the spare wheel carrier to the rear suspension beam, discard bracket and replace with Bracket (Y), secure carrier frame to Bracket (Y) using Bolt (Y1). See Sketch.
4. Loosely attach Cross Bar (A) to existing bushed chassis holes using Bolts (E) with flat washers.
5. Loosely attach Sidearms (C) and (D) to rear panel using Bolts (G) with Flat washers. Loosely attach Sidearms (C and D) to Crossbar (A) using Bolts (F).
6. Raise Spare wheel.
7. If fitting a detachable neck option, loosely secure to mainframe (A).
8. Ensuring towbar is positioned clear of spare wheel fully tighten all bolts **starting at bolts (E)**. Innermost bolts (G) require "open spanner style or crow's feet" torque wrench.
9. Check spare wheel can be lowered and raised correctly (it is normal for the wheel to rub against mainframe as it is lowered/raised but must be clear when fully up).
10. Refit Bumper Beam using Bolts (H) with Flat washers. **(Use upper set of holes on models with additional lower skirt)**
11. Refit Bumper – Detachable option only– The design of this towbar allows the bumper to be fitted with no cut, however the bottom edge of the bumper will be moved backwards 10mm and will change the profile slightly. To eliminate this a small 15mm deep cut may be used. (use the protruding part of towbar as guide for cut)
12. For detachable neck options use electrical plate (EP), fit socket and adjust alignment until clears bumper etc then tighten bolts (J).

Recommended torque settings: Grade 8.8 bolts: M8 - 4Nm, M10 - 52 Nm, M12 - 95 Nm, M14 - 130 Nm, M16 - 200 Nm Grade 10.9: M8 – 30Nm M12 – 130Nm

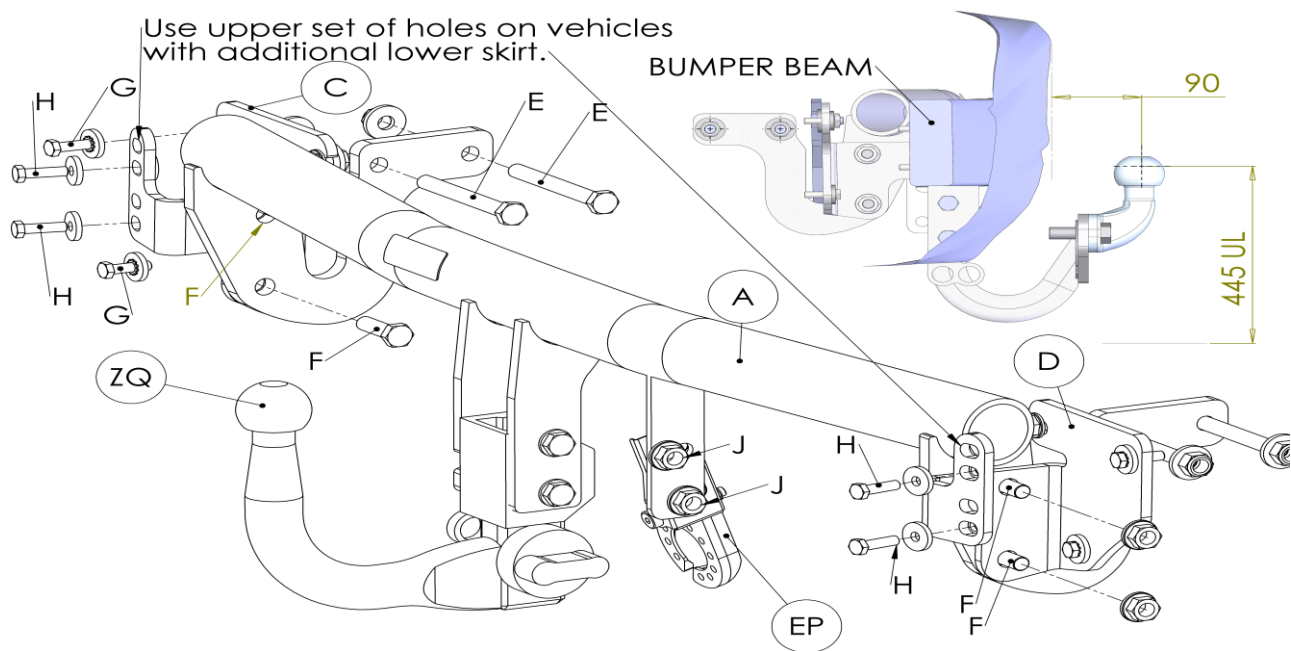

Fitting Instructions

For Mitsubishi Outlander 2012
and 2015 including the PHEV

CL114BU
TOWBAR,
DETACHABLE
SWAN NECK

MATERIALS

Y	1	Spare wheel carrier bracket
Y1	1	M8 x 20 x 1.25 Bolt and Nyloc Nut

FITTING NOTE

Increasing spare wheel clearance:

Due to a slight variation in the position of spare wheel cage, it is necessary to replace the carrier bracket shown below with Bracket (Y) supplied.

1. Remove the two hanger bracket bolts and discard bracket, secure Bracket (Y) to vehicle using original bolts, secure cage to bracket using Bolt (Y1) with Nyloc nut, tighten sufficiently to still allow cage to lower freely.

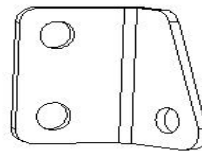
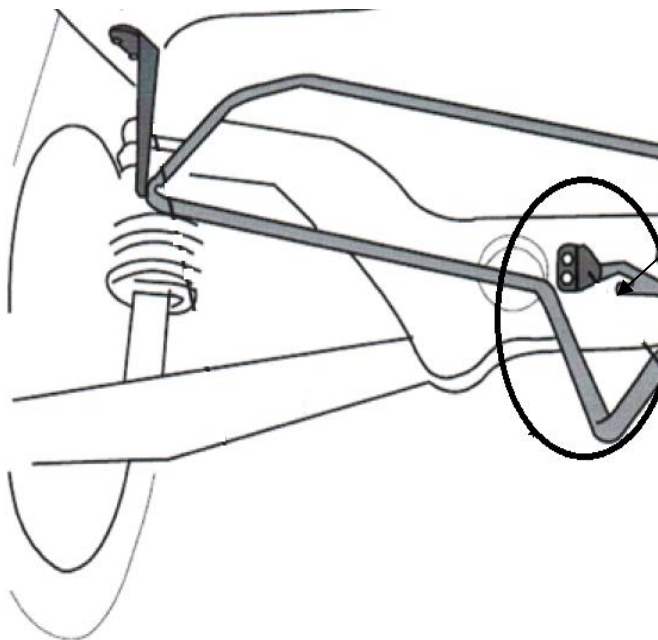

Replace bracket with
Part (Y).

2016 Models – DETACHABLE TOWBARS ONLY – DO NOT CUT BUMPER ON FIXED NECK TOWBARS



Trim clip to clear towbar housing

Notice de Montage

Pour Mitsubishi Outlander 2012
and 2015 including the PHEV

ATTELAGE,
FERRURE
DÉMONTABLE

MATERIELS

Y	1	Roue de secours console support
Y1	1	Boulons M8 x 20 x 1.25 et écrous Nyloc

MONTAGE

Agrandir l'espace pour la roue de secours:

En raison d'une légère variation de la position du panier de la roue de secours, il est nécessaire de remplacer le taquet de support ci-dessous avec la pièce (Y) fourni.

1. Retirez les deux boulons du taquet (il ne sera pas remonté), positionner le taquet (Y) au véhicule à l'aide de la visserie d'origine, et au panier à l'aide de la visserie (Y1), serrer de façon à permettre au panier de monter et descendre librement.

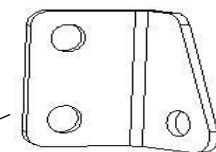
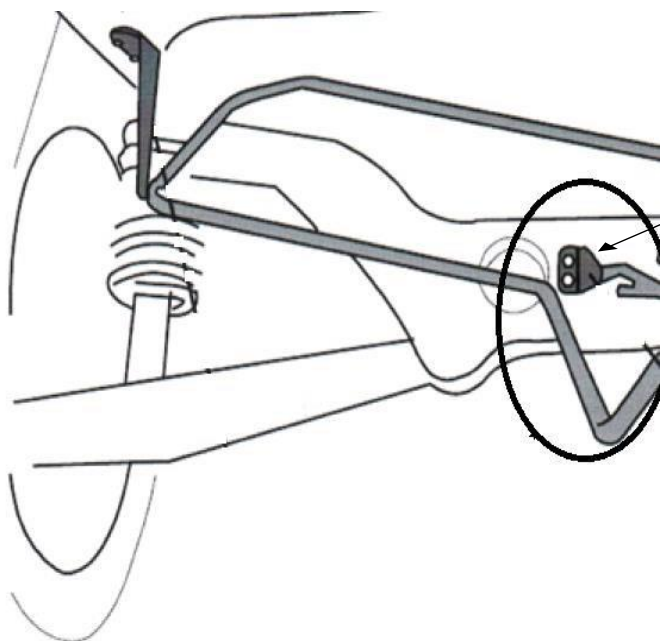

Remplacez le taquet
avec la pièce (Y)

2016 modèles - ATTELAGE RDSO SEULEMENT – AUCUNE D2COUPE POUR LES ATTELAGE FIXE



Coupez clip pour libérer l'espace pour le receveur de la RDSO